

NEIGHBORHOOD SUPPORT

OPEN HOUSE

WED. MAY 15th

6:30pm till 8:00pm

Pringle Creek Painter's Hall

The Morningside Neighborhood Association Board of Directors is hosting our annual open house for residents and business owners on Wednesday **May 15, 2019** from 6:30pm until 8:00pm at Pringle Creek Community Painter's Hall. This open house will provide guests with opportunities to connect with neighbors, speak with City of Salem staff, and learn more about their community and local businesses.

Please consider:

- **Donating ice cream, drinks, snacks, or other giveaways**
- **Make a cash donation to support this fun, family-friendly event**
- **Attend the open house on May 15th.**

(All donations are tax deductible. Donations should be payable to the City of Salem with the memo line indicating funds are for the Morningside Neighborhood Association Trust and Agency Account. Donors will receive an acknowledgement letter from the City of Salem for funds or goods donated).

Your help is needed and greatly appreciated.

Last year's Sponsors:

Ace Hardware, City of Salem, Dutch Bros., Los Arcos, Natural Grocers, Original Pancake House, Roth's Vista Market, Soup R Meals, Trader Joes, UPS Store.

MORNINGSIDE NEIGHBORHOOD ASSOCIATION



1976-2019

**BRING THE
FAMILY!!**

**NEIGHBORHOOD SUPPORT
ANNUAL OPEN HOUSE
WED. MAY 15th 6:30pm till 8:00pm**

Pringle Creek Community

Painter's Hall

3911 Village Center Dr. SE



Morningside Neighborhood Association presents our annual neighborhood support night, a **FREE** family-friendly event where neighbors can:

- Meet other neighbors, City of Salem Officials and Staff.
- Interact with Police, Fire Staff, CERT & Local Businesses.

• Door Prizes at 6:45pm, 7:15pm, 7:30pm



Contact us: via email sidrakdragon@live.com
Visit our Website: www.morningsidena.org



DIRECTIONS SEE MAP ON BACK



MORNINGSIDE NEIGHBORHOOD ASSOCIATION MAP

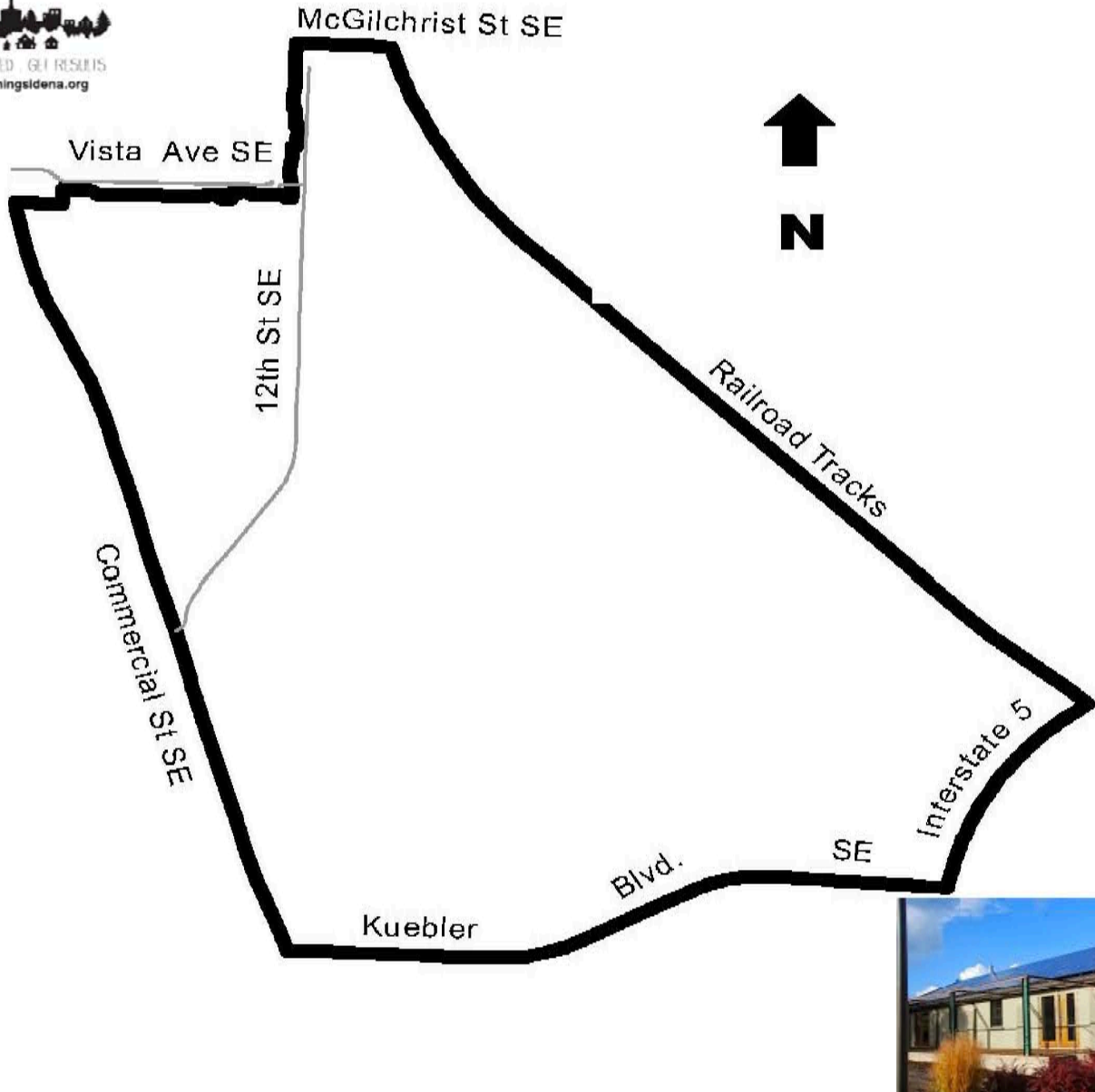

Painter's Hall 3911 Village Center Drive SE

DIRECTIONS:

Starting from Fred Meyer

- **Head southeast on Commercial St SE toward Madrona Ave SE**
- **Turn left at the 1st cross street onto Madrona Ave SE**
- **Turn right onto Fairview Industrial Dr SE**
- **Turn right onto Lindburg Rd**
- **Turn right onto Village Center Dr SE (Destination will be on the right)**